

# Comfosystems ComfoWell installation instructions

**zehnder**

always  
around you

Heating

Cooling

Fresh Air

Clean Air

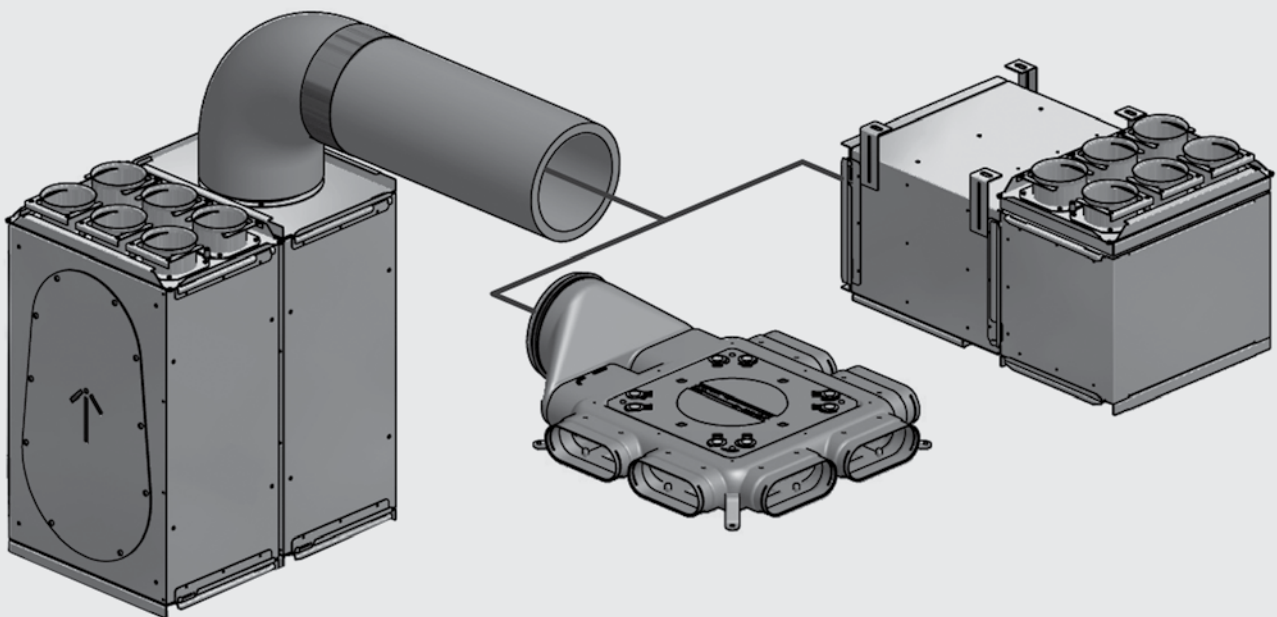

# The ComfoWell system

## Installation instructions

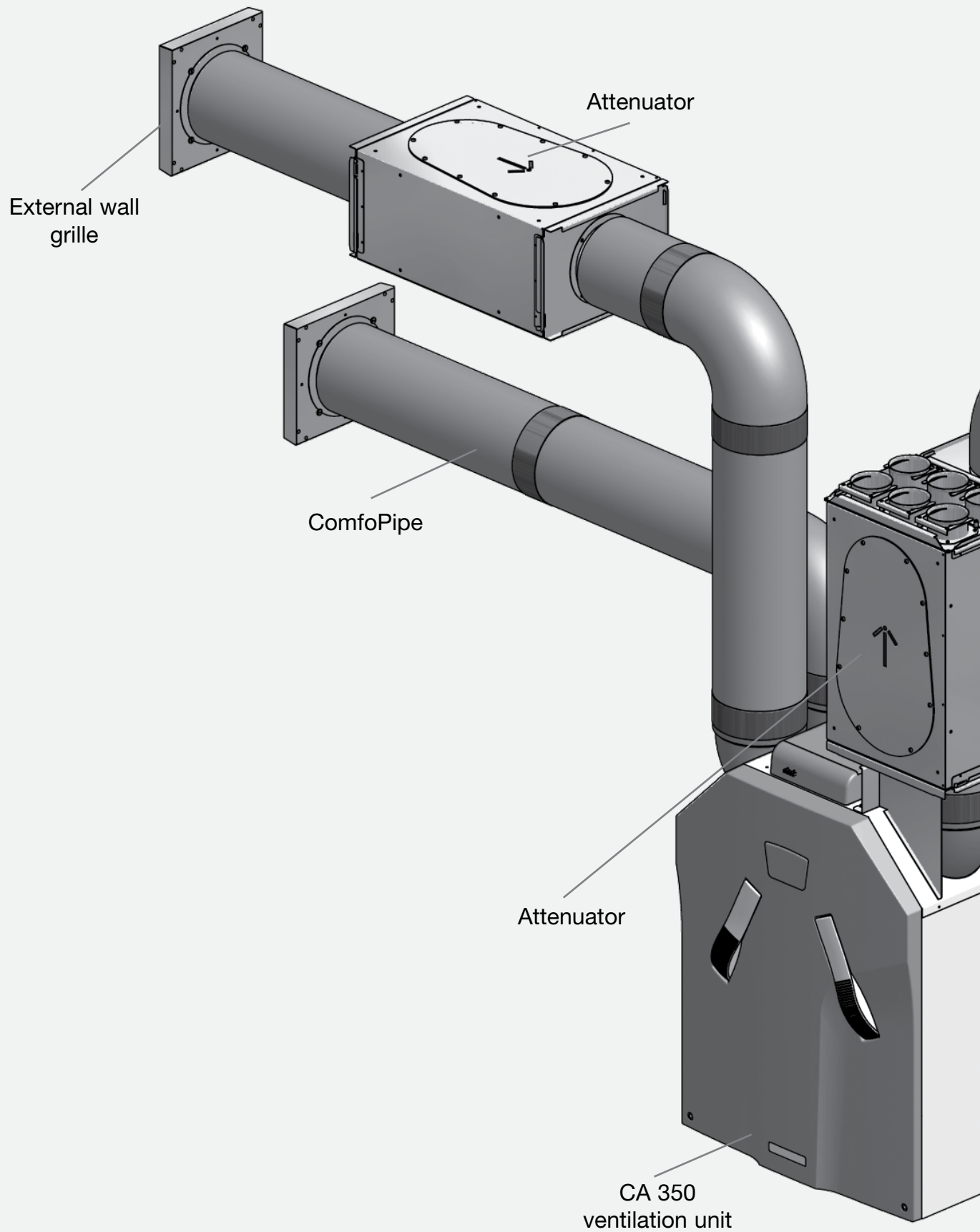

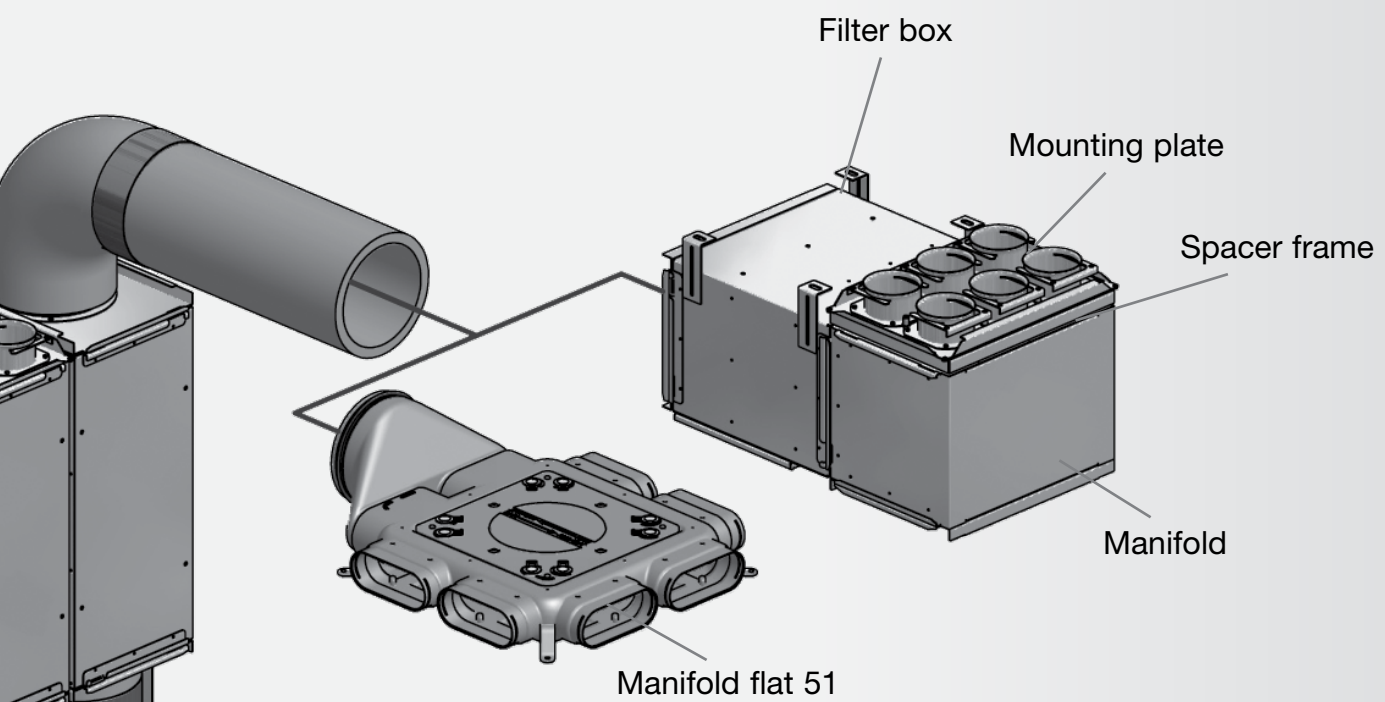

ComfoWell Series 220 system	2
ComfoWell Series 320 system	12
ComfoWell Series 520 system	26

# ComfoWell Series 220 system

## Installation example

Individual

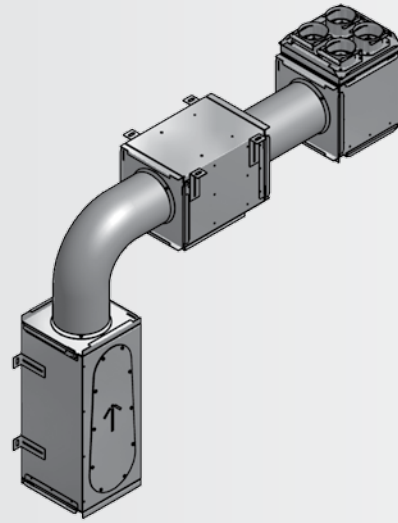

Composite

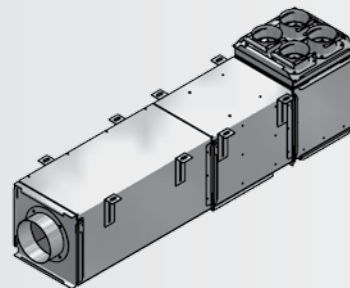

On unit

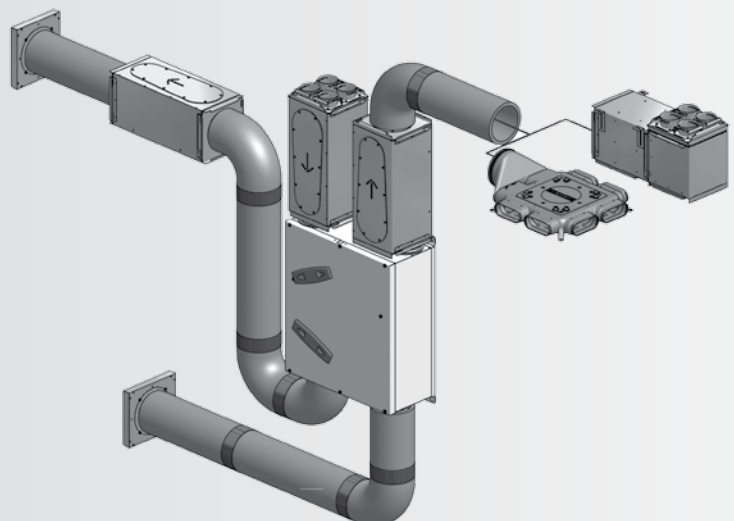

# ComfoWell Series 220 system

## Accessories

Product	Description
	Width 220 up to 4 ComfoTubes Attenuator CW-S-220 <b>990 323 500</b>
	End piece CW-P 220-DN125 <b>990 323 510</b>
	Installation set CW-K 220-CA140 <b>990 323 515</b>
	Mounting plate CW-M 220-4xCT 75 <b>990 323 520</b>
	Mounting plate CW-M 220-4xCT 90 <b>990 323 521</b>
	Manifold CW-D 220 <b>990 323 530</b>

Product	Description
	Filter housing CW-F 220 <b>990 323 550</b>
	Replacement filter F7 for filter housing CW-F 220 <b>990 323 600</b>
	Replacement filter F9 for filter housing CW-F 220, 2 pcs. <b>990 323 601</b>
	Replacement activated charcoal filter for filter housing CW-F 220 <b>990 323 602</b>
	Spacer frame <b>990 323 534</b>

# ComfoWell CW 220

## Installation sequence



1. Fit ComfoWell together

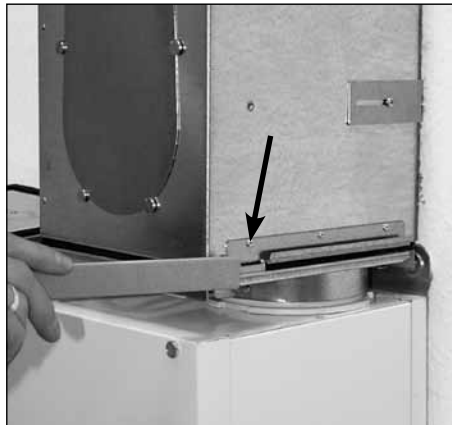

2. Make all connections using the clamping rail

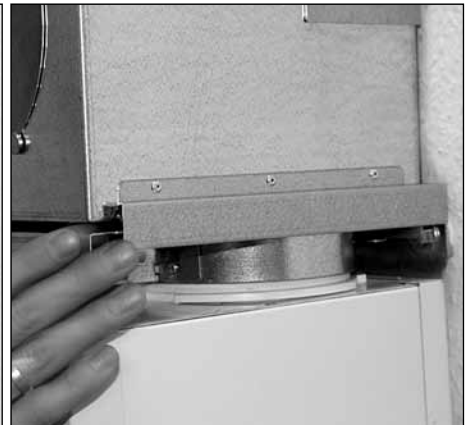

3. OK

## Securing



1. Unscrew the mounting brackets

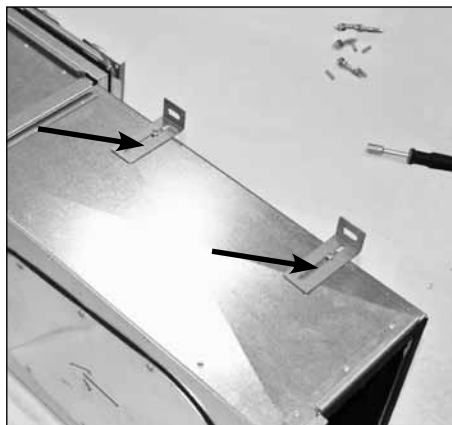

2. Rotate and secure mounting brackets

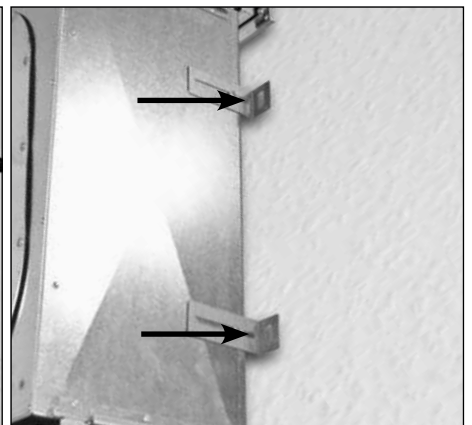

3. Secure the element to the wall

# ComfoWell CW 220

## Installation options

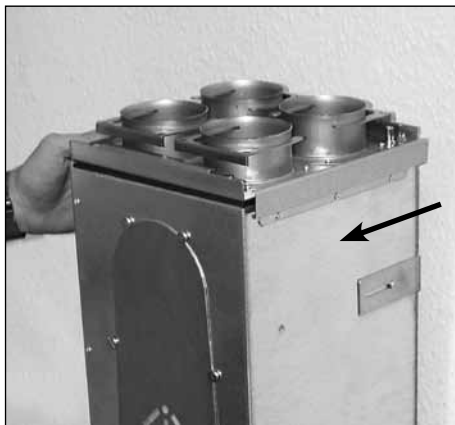

1. Mounting plate

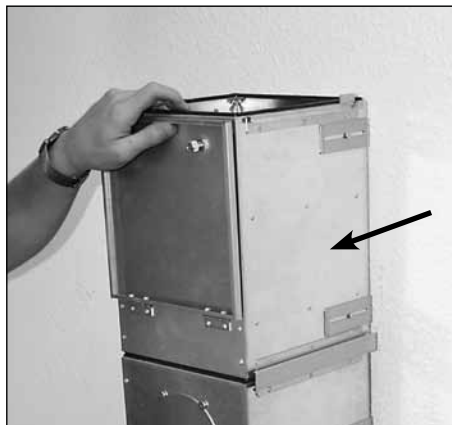

2. Filter housing (correct)

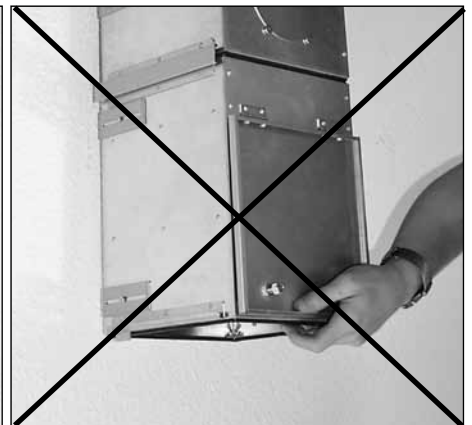

3. Do not install filter housing with the opening pointing downwards (incorrect)

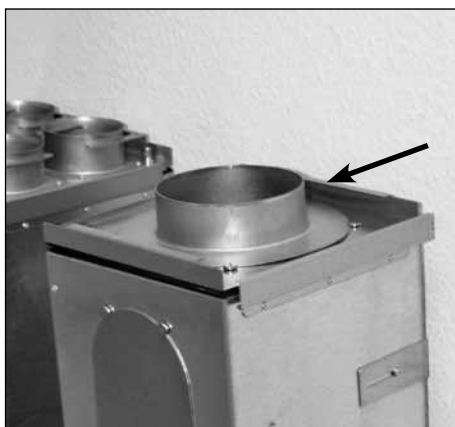

4. End piece

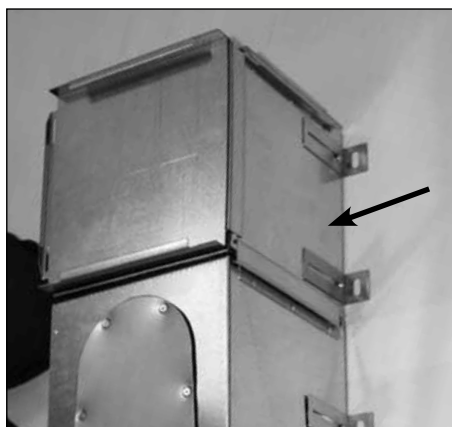

5. Manifold

# ComfoWell CW 220

## Filter installation



1. Undo screws



2. Open cover

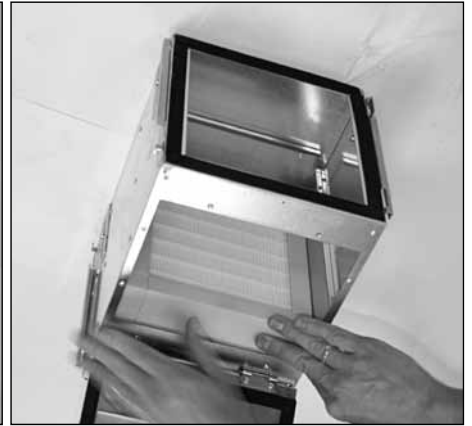

3. Install filter



4. Close cover and tighten screws



# ComfoWell CW 220 activated charcoal

## Filter installation



1. Undo screws



2. Open cover and unscrew clamping rail on cover

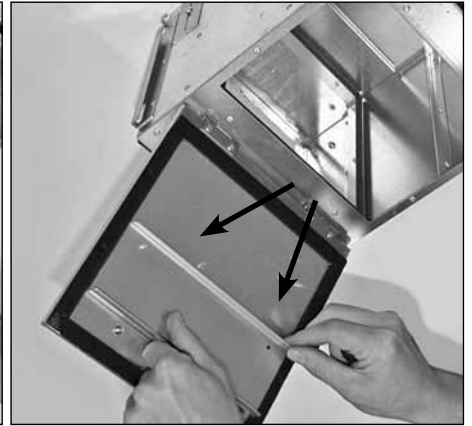

3. Rotate clamping rail

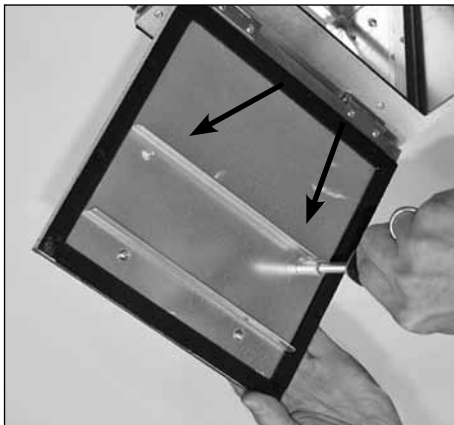

4. Attach clamping rail



5. Unscrew clamping rail from housing bottom



6. Rotate and secure



7. Install filter



8. Close cover and tighten screws

# ComfoWell CW 220

## Manifold conversion



1.



2. Pull off clamping rail

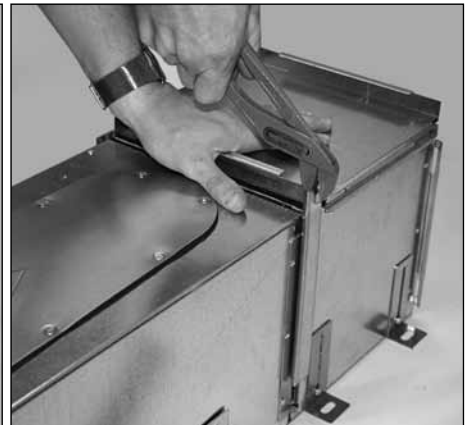

3. OK



4. Remove cover

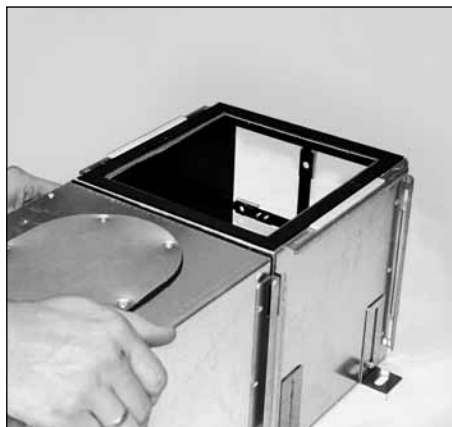

5. OK

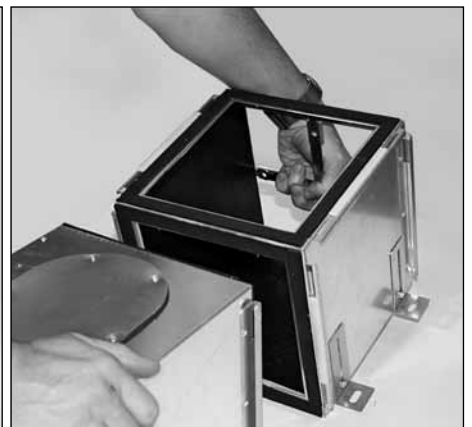

6. Rotate manifold

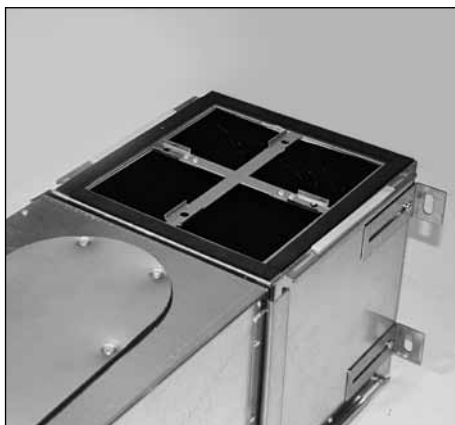

7. OK



8. Fit either mounting plate or distance frame

## ComfoWell CW 220

### Installing the manifold under the ceiling



1. Screw the threaded rods into the mounting plate

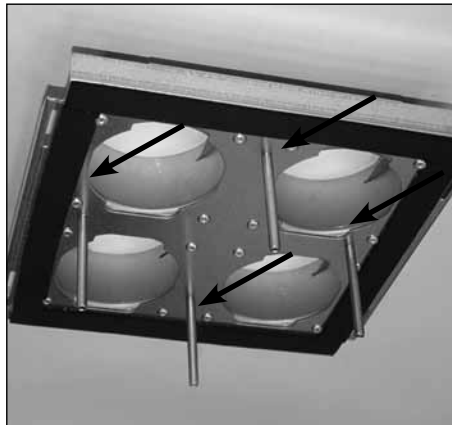

2. OK

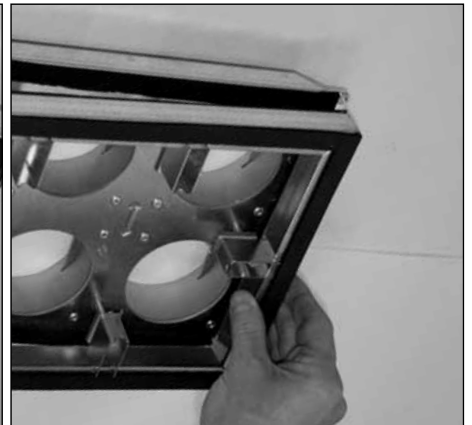

3. Use spacer frame as required (to compensate for irregularities)

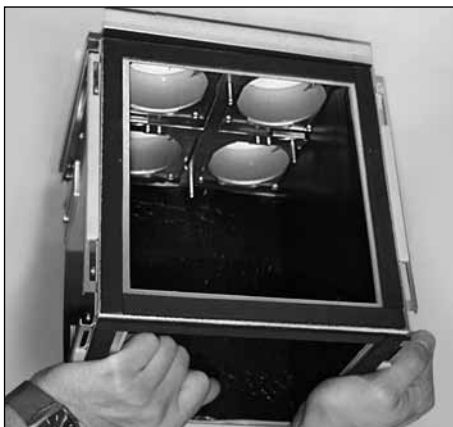

4. Push manifold onto the threaded rods until the manifold locks in place



5. Secure manifold using M6 nuts



6. Tighten all nuts with a 6 mm socket

# ComfoWell CW 220 and CA 140

## Installation sequence



1. CA 140 installation set



2. Attach end plate to CA 140



3. Tighten clamping ring



4. Mount ComfoWell on the end plate

# ComfoWell CW 220 and CA 140

## Attenuator inspection opening



1. Undo screws

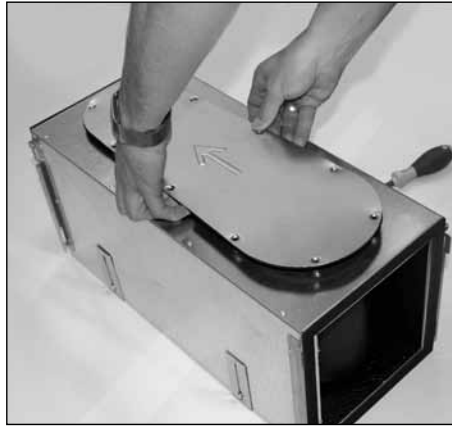

2. Carefully pull out the core element

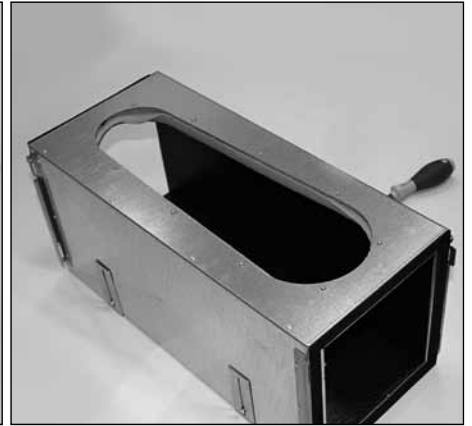

# ComfoWell Series 320 system

## Installation example

Individual

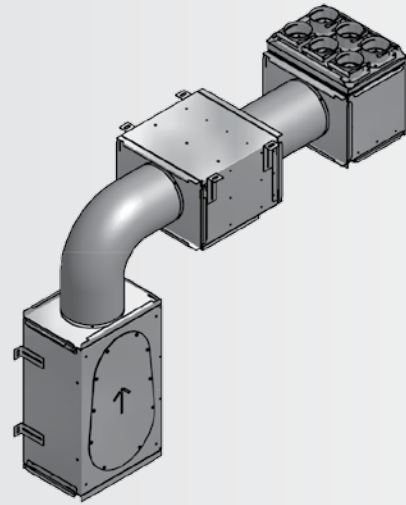

Composite

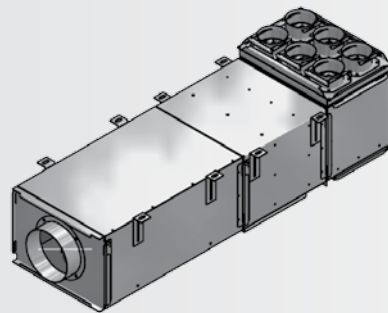

On unit

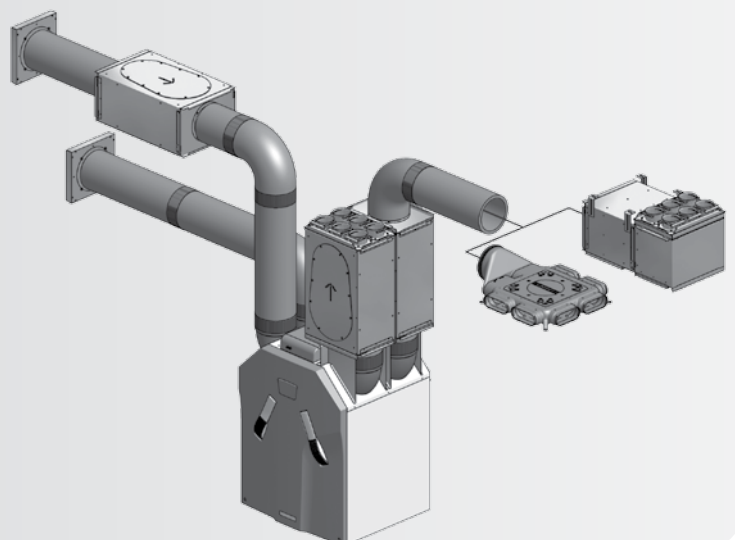

# ComfoWell Series 320 system

## Installation example

On unit CA 140

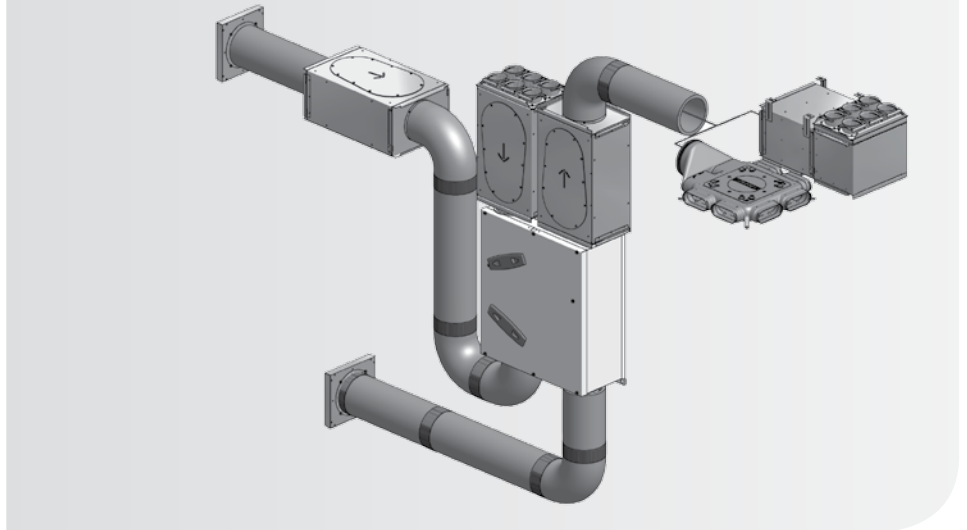

On unit CA 200

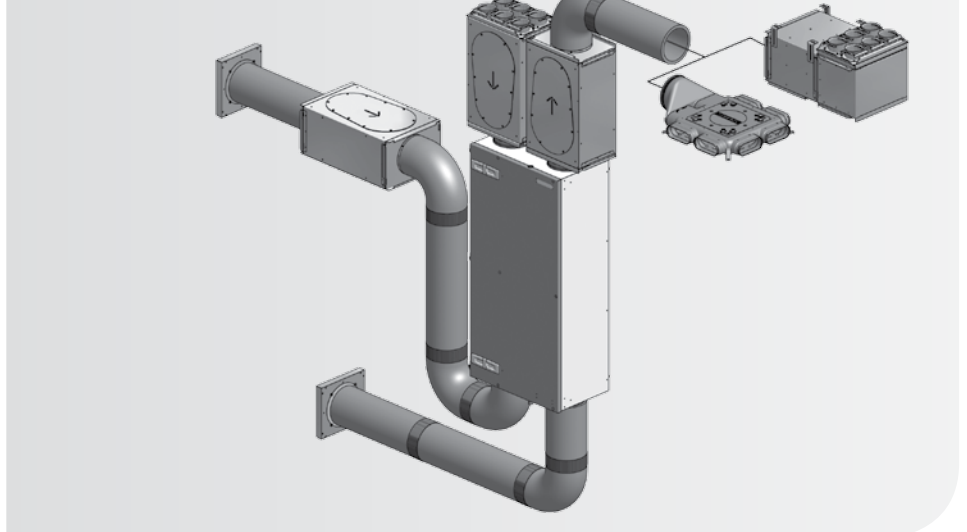

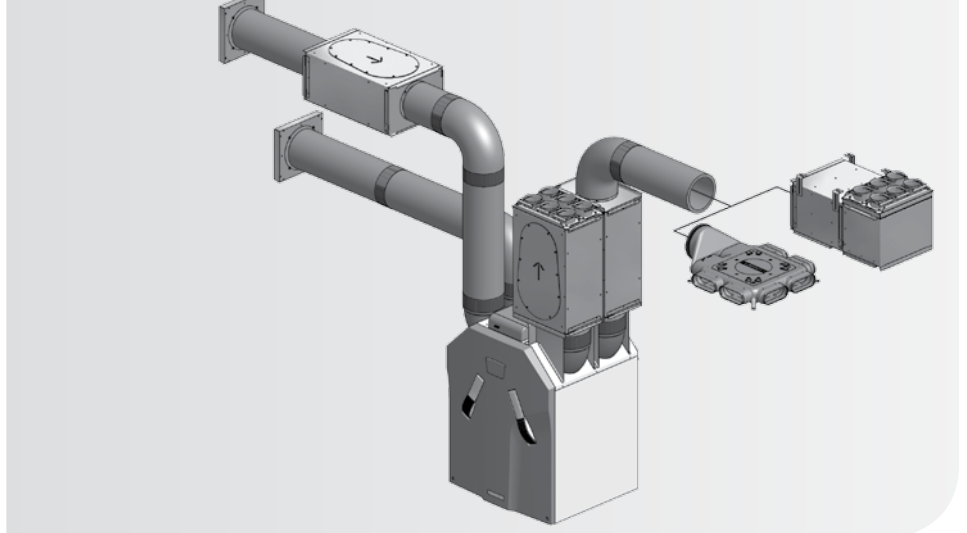

On unit CA 350



# ComfoWell Series 320 system

## Accessories

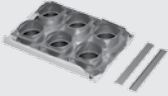
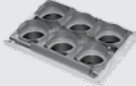
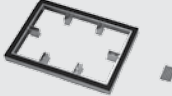
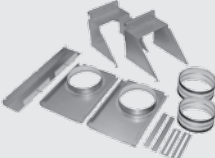
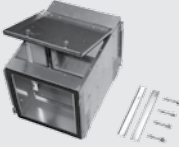
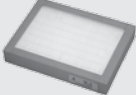
Product	Description
	Width 320 up to 6 ComfoTubes Attenuator CW-S 320 <b>990 323 501</b>
	Attenuator with fixed endplates CW-SF 320 <b>990 323 503</b>
	End piece CW-P 320-DN125 <b>990 323 511</b>
	End piece reduced CW-P 320-DN150 <b>990 323 562</b>
	End piece CW-P 320-DN160 <b>990 323 512</b>
	End piece CW-P 320-DN180 <b>990 323 527</b>
	Mounting set CW-K 320 CA 140 <b>990 323 516</b>
	Mounting set CW-K 320 CA 200 <b>990 323 517</b>

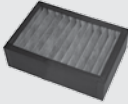
Product	Description
	Mounting plate CW-M 320-6xCT 75 <b>990 323 516</b>
	Mounting plate CW-M 320-6xCT 90 <b>990 323 523</b>
	Spacer frame <b>990 323 535</b>
	Mounting set for 2 attenuators, width 320 on unit with 1 pair eccentric sleeves for min. overall width, 1 U-profile 1 + support CW-K 320-CA350 <b>990 323 526</b>
	Filter housing CW-F 320 <b>990 323 551</b>
	Replacement filter F7 for filter housing CW-F 320, 2 pcs. <b>990 323 603</b>
	Replacement filter F9 for filter housing CW-F 320, 2 pcs. <b>990 323 604</b>
	Replacement activated charcoal filter for filter housing CW-F 320, 2 pcs. <b>990 323 605</b>



# ComfoWell CW 320

## Installation sequence



1. Fit ComfoWell together

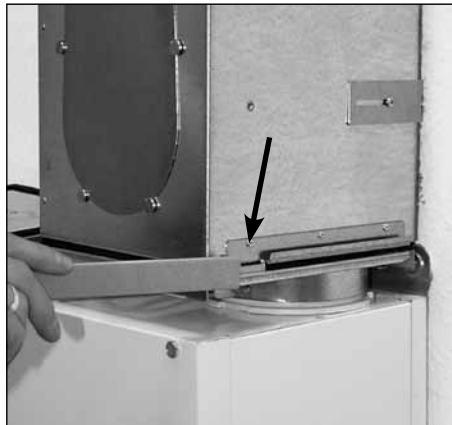

2. Make all connections using the clamping rail

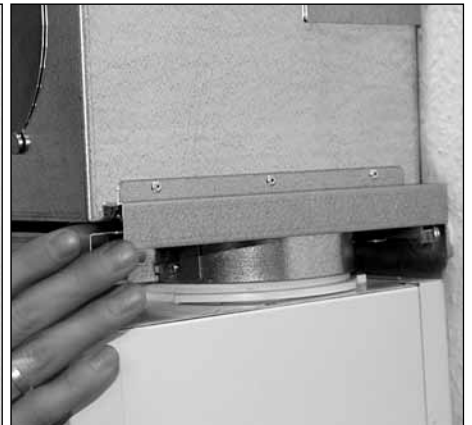

3. OK

## Attaching to the wall



1. Unscrew the mounting brackets

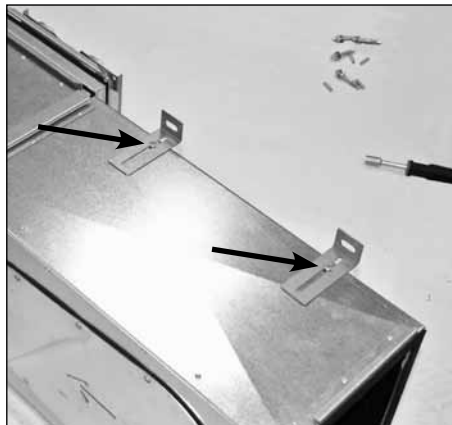

2. Rotate and secure mounting brackets

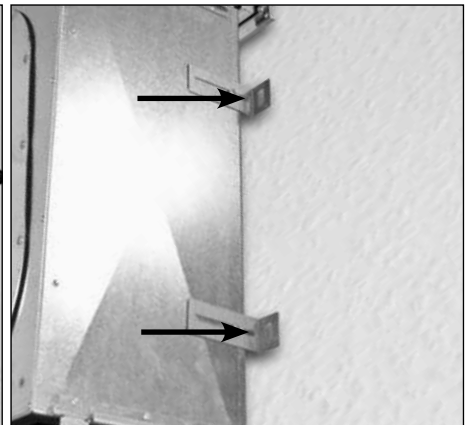

3. Secure the element to the wall

# ComfoWell CW 320

## Joining together



1.

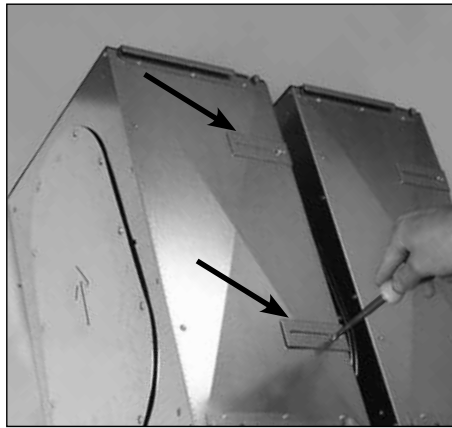

1a. Unscrew the mounting brackets

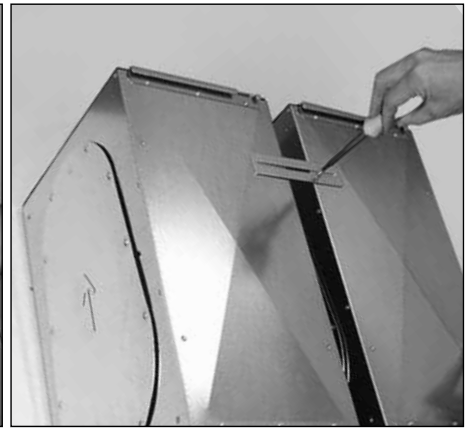

1b.



1c. OK

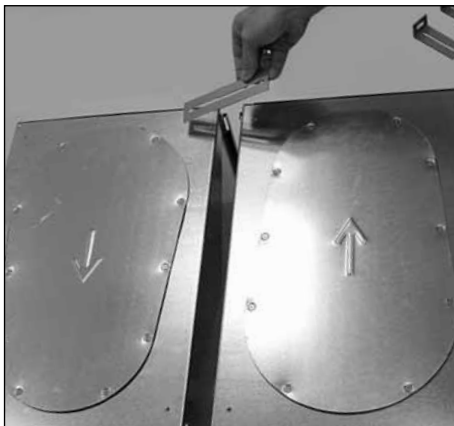

2. Screw on fastening sheet



2a. OK

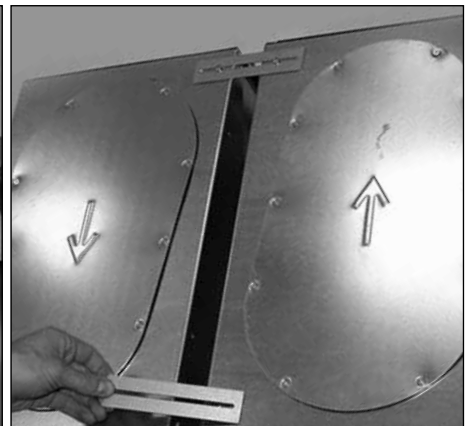

2b. Screw on second fastening sheet

# ComfoWell CW 320

## Installation options

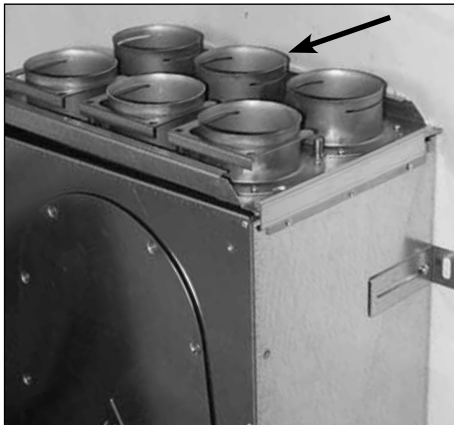

1. Mounting plate

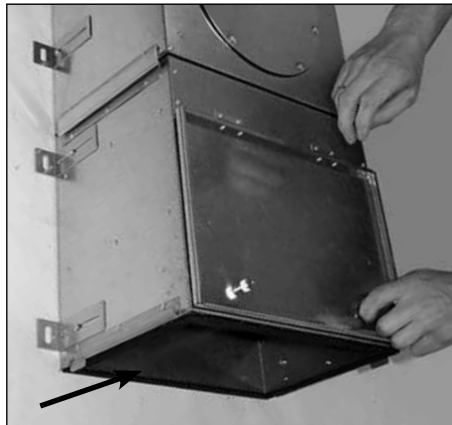

2. Filter housing

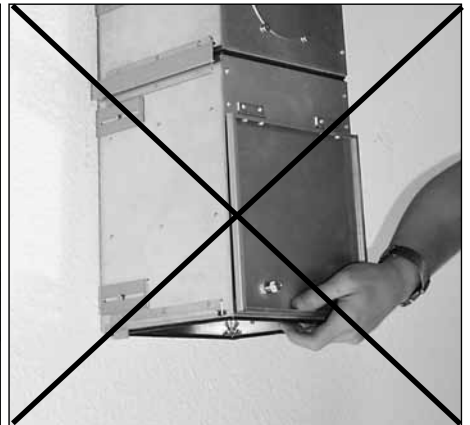

3. Wrong  
Do not install with the opening pointing downwards

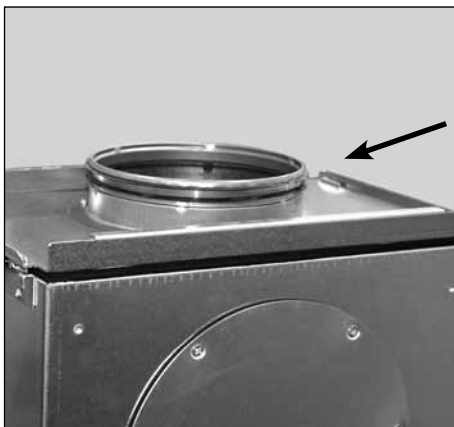

4. End piece

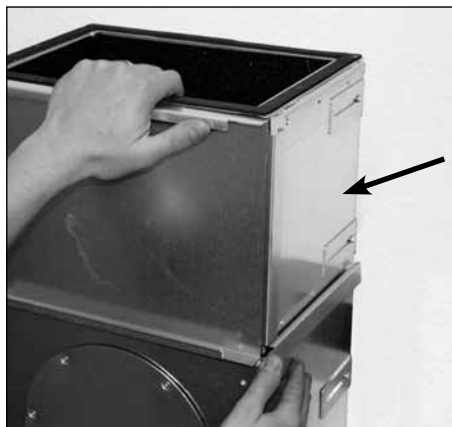

5. Manifold

# ComfoWell CW 320

## Filter installation



1. Undo screws



2. Open cover

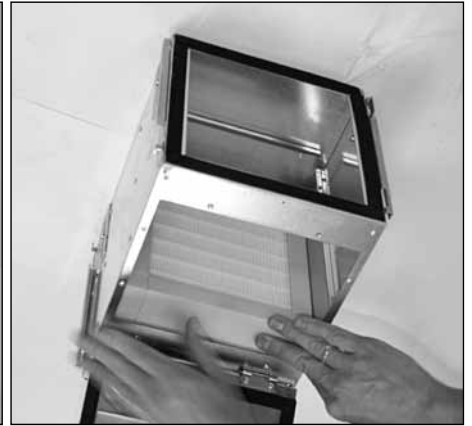

3. Install filter



4. Close cover and tighten screws

# ComfoWell CW 320 activated charcoal filter

## Installation



1. Undo screws



2. Open cover and unscrew clamping rail on cover

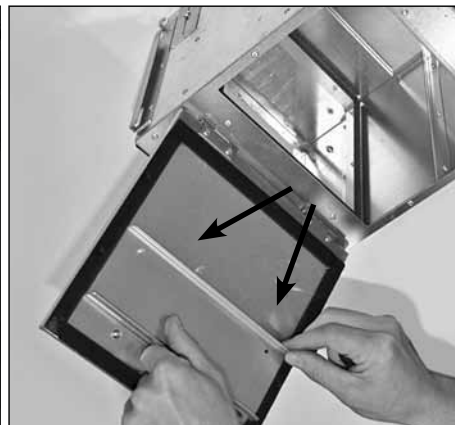

3. Rotate clamping rail

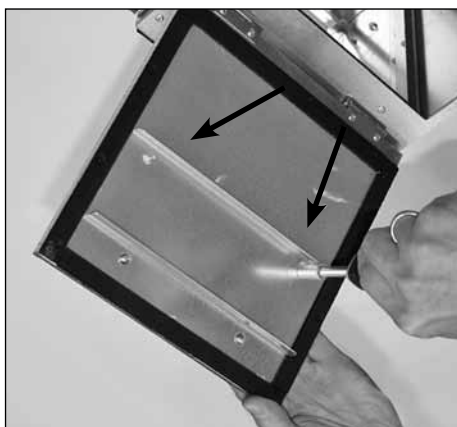

4. Attach clamping rail



5. Unscrew clamping rail from housing bottom



6. Rotate and secure



7. Install filter



8. Close cover and tighten screws

# ComfoWell CW 320

## Manifold conversion



2. Pull off clamping rail



3. OK



4. Remove cover

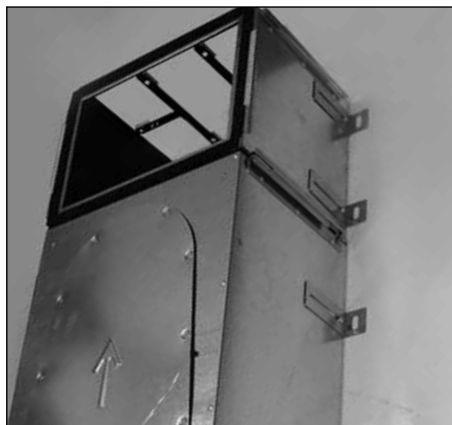

5. OK

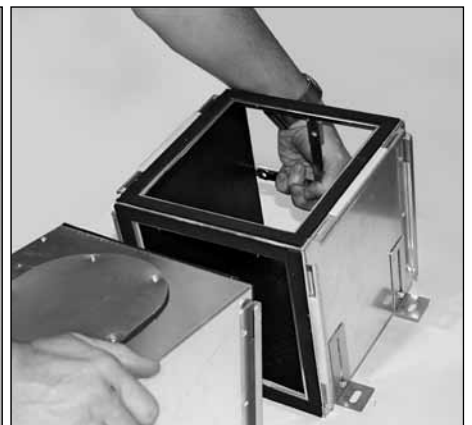

6. Rotate manifold



7. OK



8. Fit either mounting plate or distance frame

# ComfoWell CW 320

Installing the manifold under the ceiling using the spacer frame



1. Screw the threaded rods into the mounting plate



2. OK



3. Push the spacer frame onto the threaded rods



4. Push manifold onto the threaded rods until the manifold locks in place



5. Secure manifold using M6 nuts

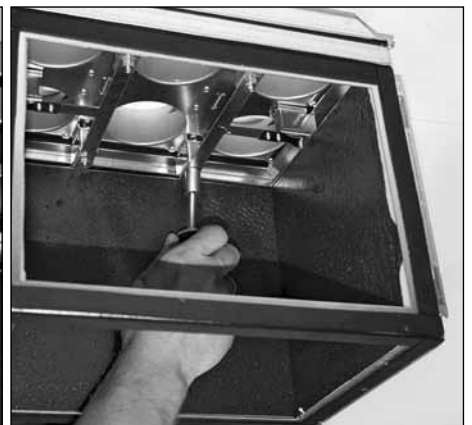

6. Tighten all nuts with a 6 mm socket

## CW 320 attenuator inspection opening



1. Undo screws

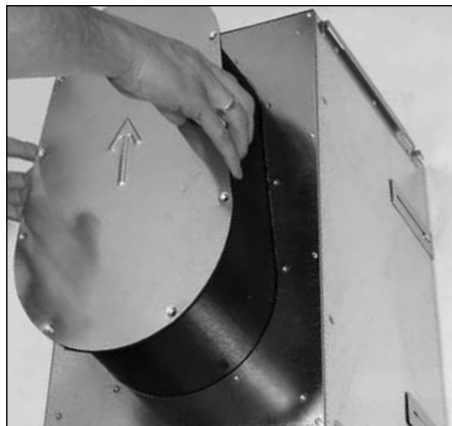

2. Carefully pull out the core element

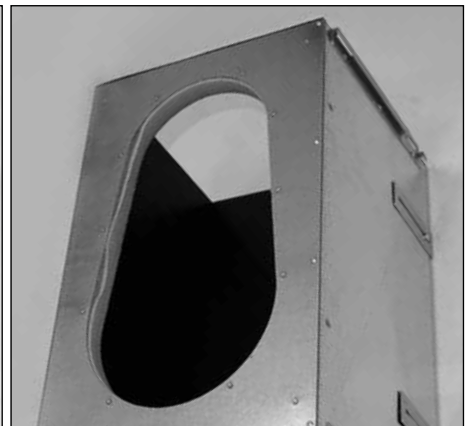

# ComfoWell CW 320 and CA 140

## Installation sequence

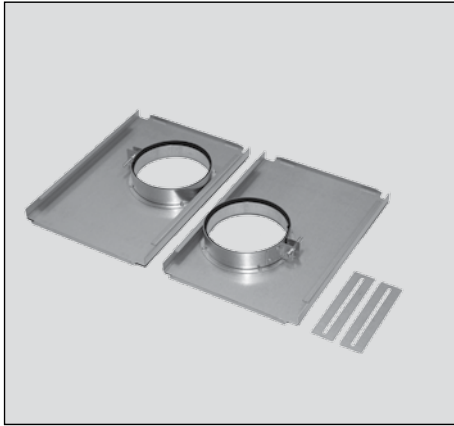

1. CW-K 320 installation set  
CA 140



2. Attach end plate to CA 140

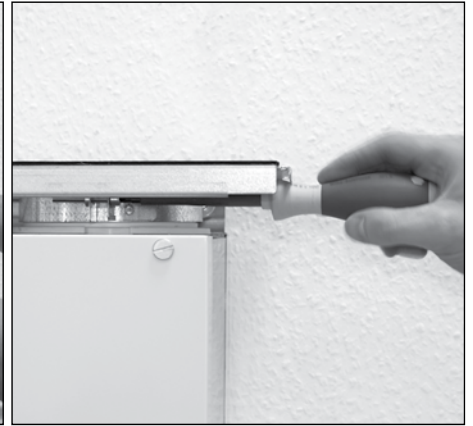

3. Tighten clamping ring



4. Mount ComfoWell on the  
end plate



# ComfoWell CW 320 and CA 200

## Installation sequence



1. CW-K 320 installation set  
CA 200



2. Attach end plate to CA 200



3.



4. Place attenuator on the end  
plate

# ComfoWell CW 320 and CA 350

## Installation sequence

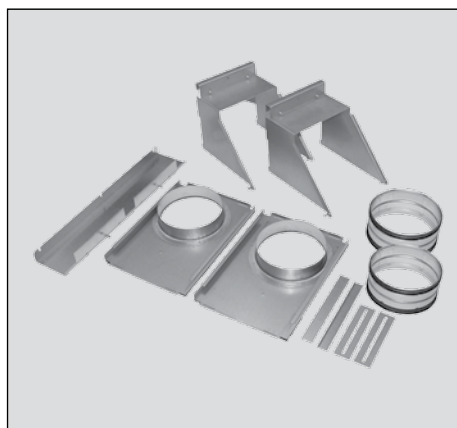

1. CW-K 320 installation set  
CA 350

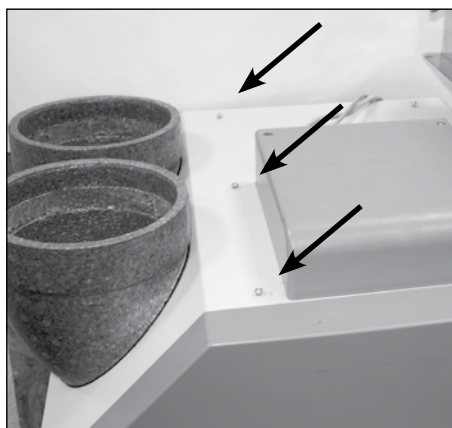

2. Unscrew screws approx.  
3 mm out of the CA 350



3. Locate U-profile and screw  
onto the CA 350



4. Attach the mountings to the  
U-profile

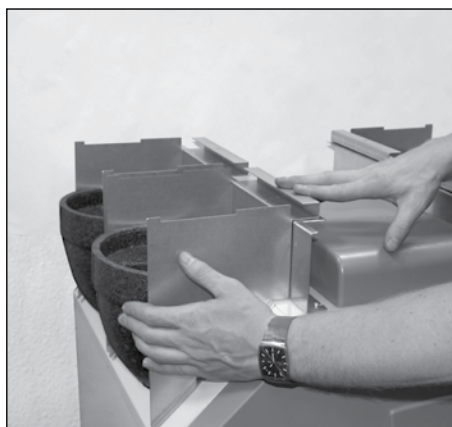

5. OK



6. Insert the 160 mm nipple into  
the CA 350



7. Mount end piece plate



8. Secure two end piece plates  
with one screw each



9. Place ComfoWell on the end  
plate



# ComfoWell Series 520 system

## Installation example

Individual

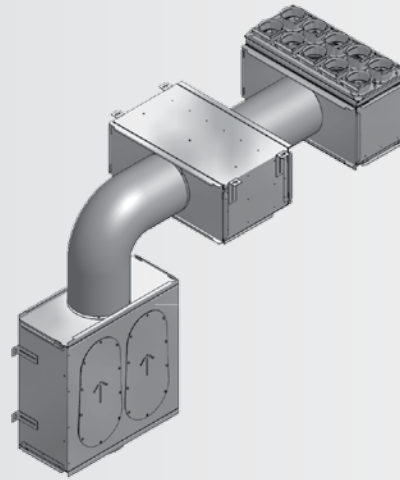

Composite

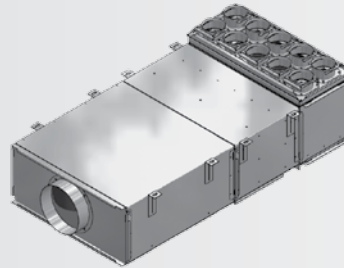

# ComfoWell Series 520 system

## Installation example

On unit CA 350

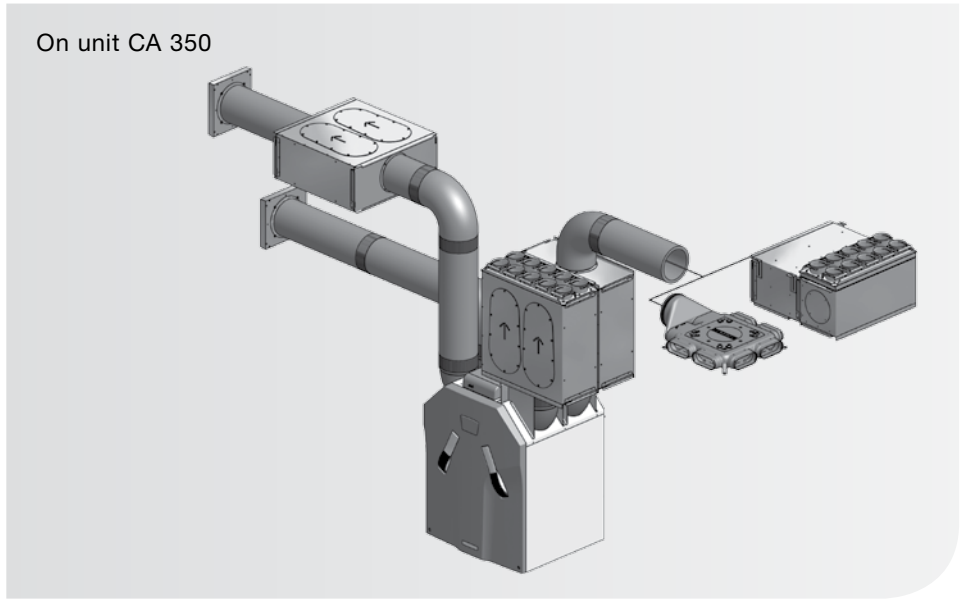

On unit CA 550

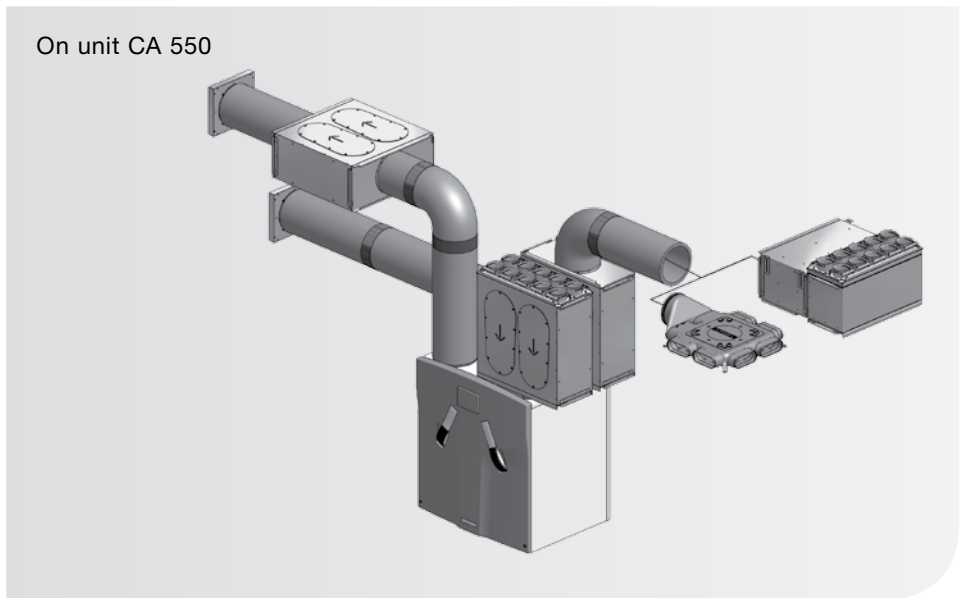

# ComfoWell Series 520 system

## Accessories

Product	Description
	Attenuator CW-S-520 <b>990 323 502</b>
	End piece CW-P 520-DN200 <b>990 323 514</b>
	End piece reduced CW-P 520-DN180 <b>990 323 513</b>
	End piece reduced CW-P 520-DIN160 <b>990 323 518</b>
	Mounting set CW-K 520-CA350 <b>990 323 518</b>
	Mounting set CW-K 520-CA 550 <b>990 323 519</b>
	Mounting plate CW-M 520-10x CT 75 <b>990 323 524</b>

Product	Description
	Mounting plate CW-M 520-10xCT 90 <b>990 323 525</b>
	Manifold CW-D 520 <b>990 323 532</b>
	Spacer frame CW 520 <b>990 323 536</b>
	Filter housing CW-F 520 <b>990 323 552</b>
	Replacement filter F9 for filter housing CW-F 520, 2 pcs. <b>990 323 606</b>
	Replacement filter F7 for filter housing CW-F 520, 2 pcs. <b>990 323 607</b>
	Replacement activated charcoal filter for filter housing CW-F 520, 2 pcs. <b>990 323 608</b>

# ComfoWell CW 520

## Installation sequence

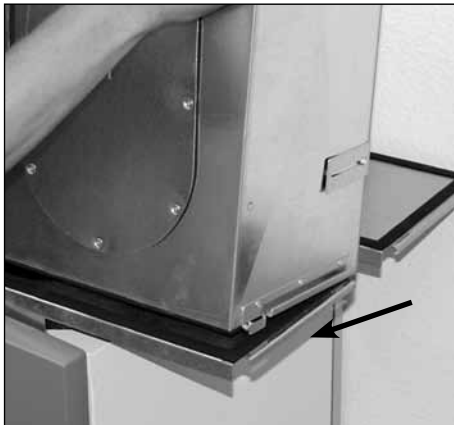

1. Fit ComfoWell together

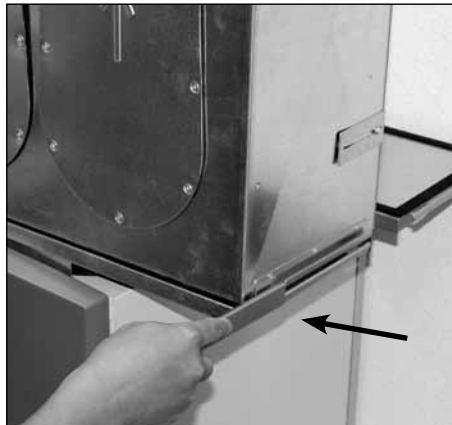

2. Make all connections using the clamping rail



3. OK

## Securing



1. Unscrew the mounting brackets

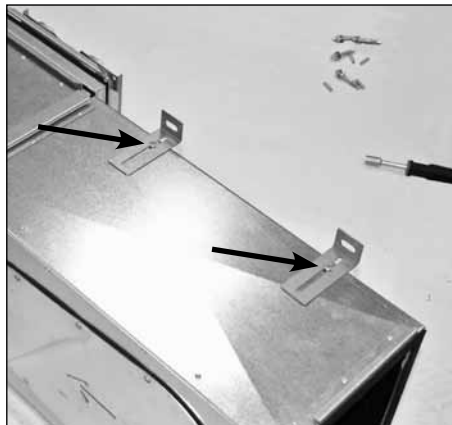

2. Rotate and secure mounting brackets

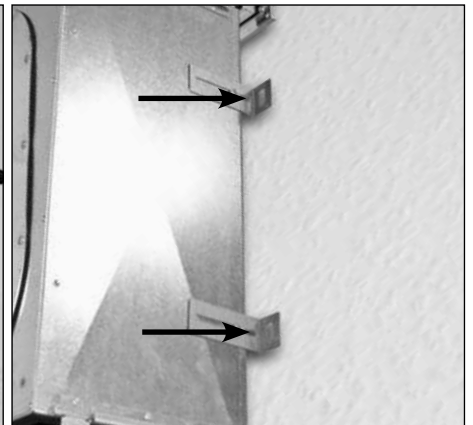

3. Secure the element to the wall

## Joining together

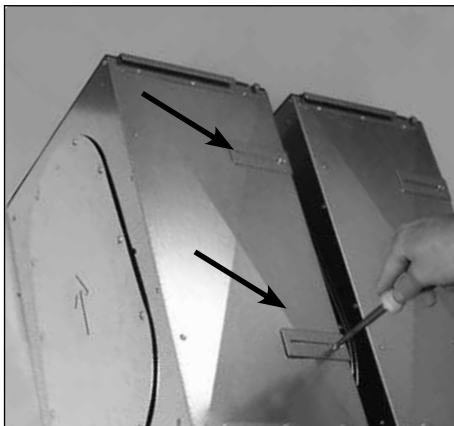

1. Unscrew the mounting brackets

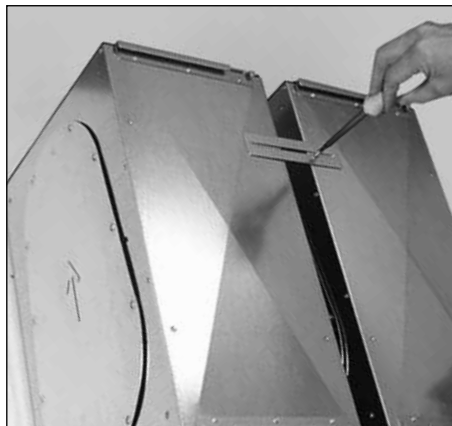

1a. Screw on fastening sheet

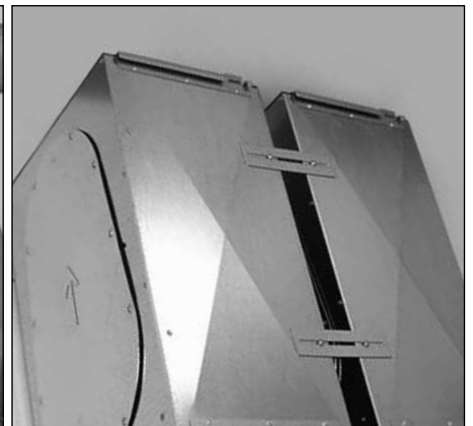

1b. OK

# ComfoWell CW 520

## Installation options

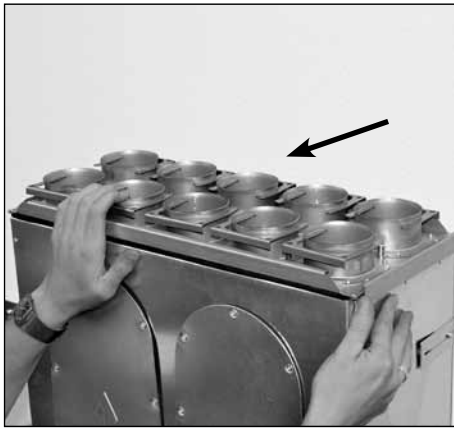

1. Mounting plate



2. Filter housing

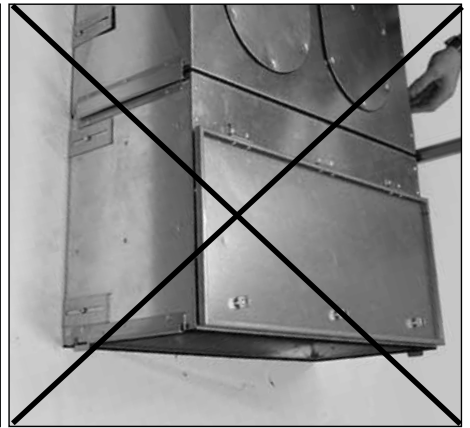

3. Wrong  
Do not install with the opening pointing downwards

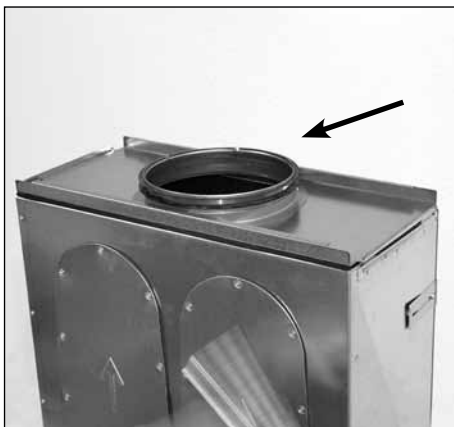

4. End piece

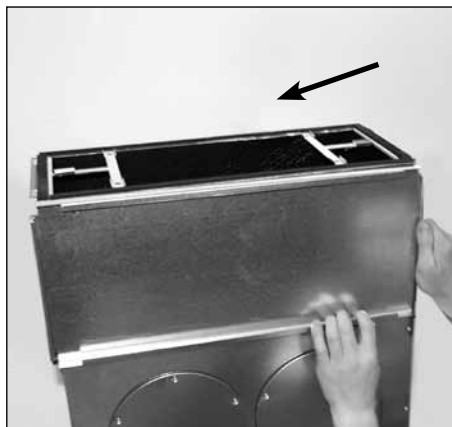

5. Manifold



# ComfoWell CW 520

## Filter installation

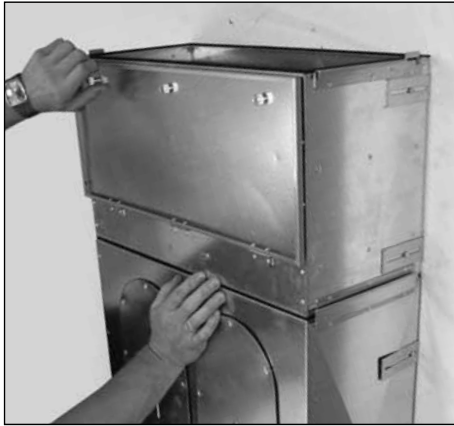

1. Undo screws



2. Open cover



3. Install filter

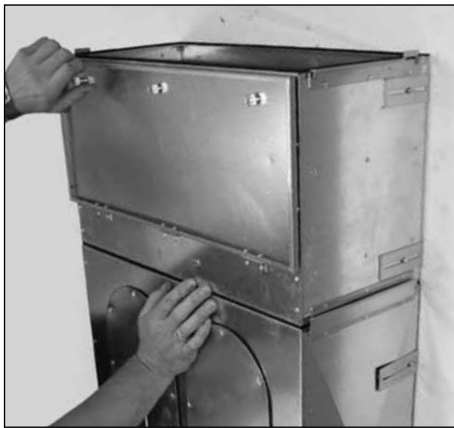

4. Close cover and tighten screws

# ComfoWell CW 520 activated charcoal filter

## Installation



1. Undo screws

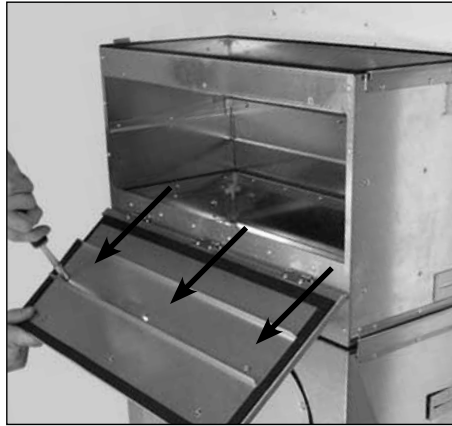

2. Open cover and unscrew clamping rail on cover



3. Rotate clamping rail



4. Attach clamping rail



5. Unscrew clamping rail from housing bottom



6. Rotate and secure



7. Install filter



8. Close cover and tighten screws

# ComfoWell CW 520

## Manifold conversion



1. Pull off clamping rails



2. Remove cover



3. Pull off clamping rail



4. Rotate



5.



6. Fit either mounting plate or distance frame

## ComfoWell CW 520

Installing the manifold under the ceiling using the spacer frame



1. Screw in threaded rods

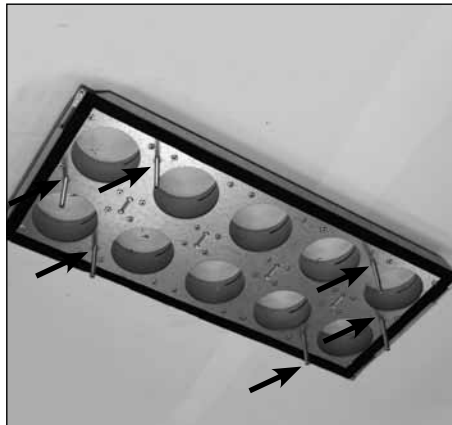

2. OK



3. Push in threaded rods



4. Push manifold onto the threaded rods until the manifold locks in place



5. Secure manifold using M6 nuts



6. Tighten all nuts with a 6 mm socket

# ComfoWell CW 520 and CA 550

## CW 520 attenuator inspection opening

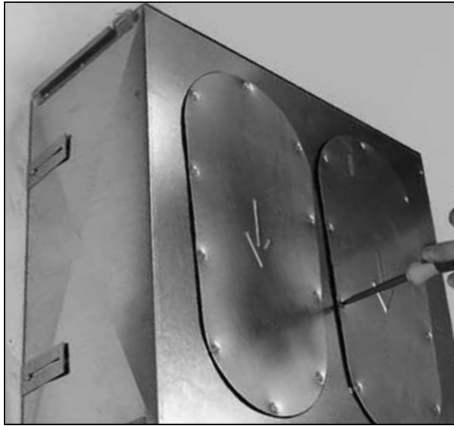

1. Undo screws

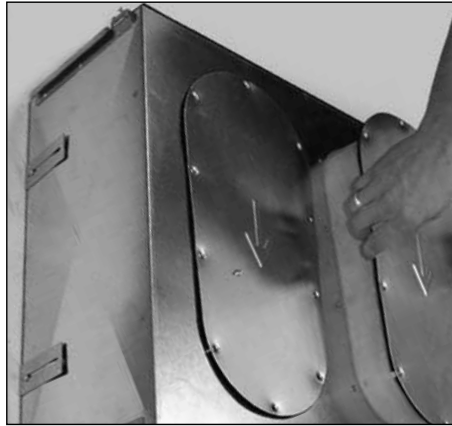

2. Carefully pull out the core element



3.

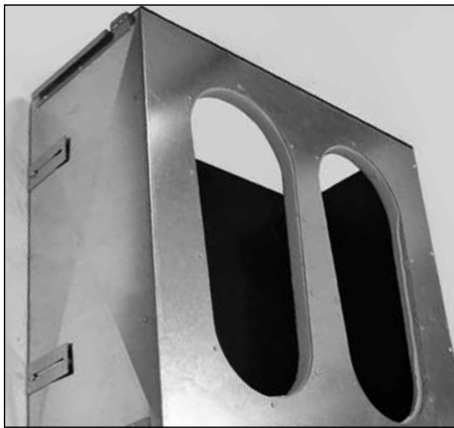

4.

# ComfoWell CW 520 and CA 550

## Installation sequence

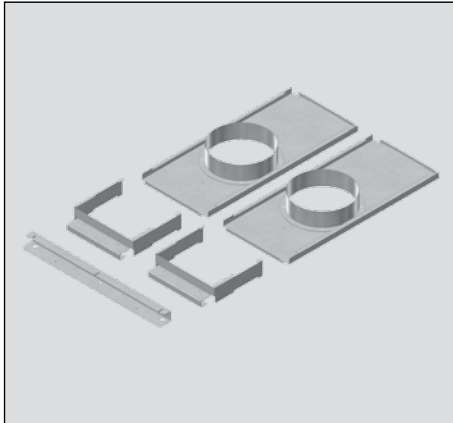

1. CA 550 CW 520 installation set



2. Unscrew screws



3. Screw U-profile to CA 550



4. Attach the mountings to the U-profile

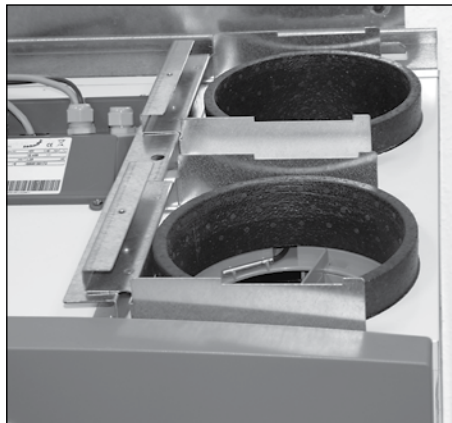

5. OK



6. Mount end piece plate



7. Secure end piece plate with one screw



8. OK

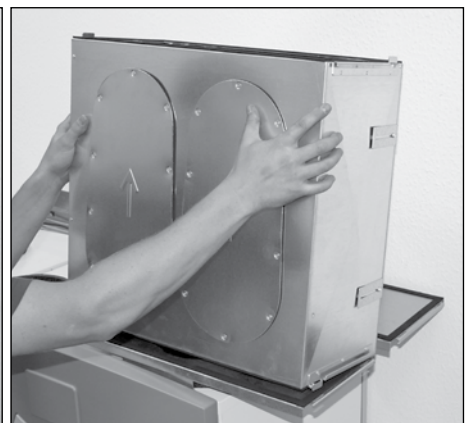

9. Place ComfoWell onto the end plate

# ComfoWell CW 520 and CA 350

## Installation sequence

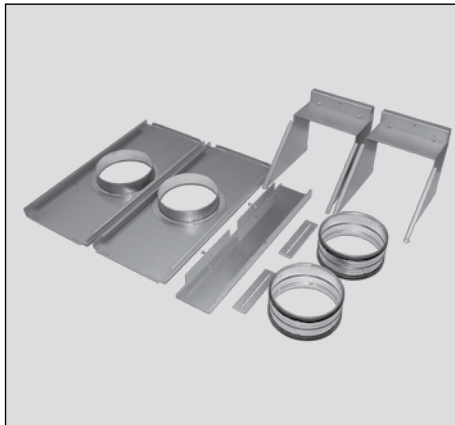

1. Installation set  
CW-K 520-CA 350

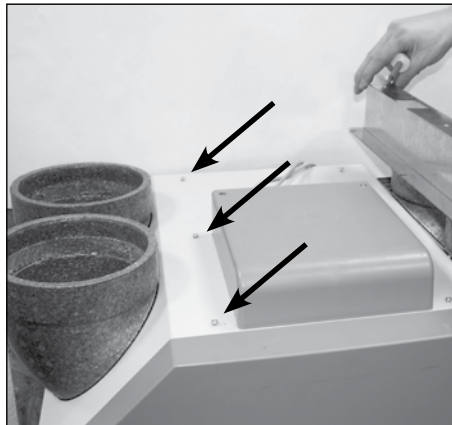

2. Unscrew screws approx.  
3 mm out of the CA 350



3. Locate U-profile and screw  
onto the CA 350



4. Attach the mounting to the  
U-profile

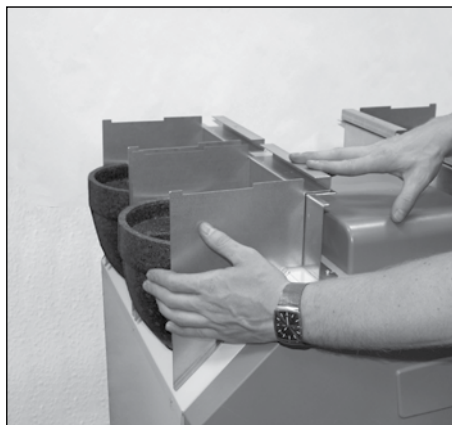

5. OK



6. Insert the 160 mm nipple  
into the CA 350



9. Mount end piece plate

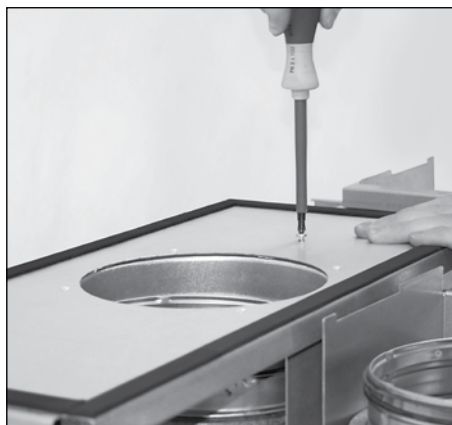

10. Secure end piece plate with  
one screw



11. OK

CDE-FLYERMA220, V0211, en, subject to modification